

CEILING KEY	
KEY	DESCRIPTION
BH	BULKHEAD WHERE CHANGE IN CEILING HEIGHT
BK	UNDERSIDE OF BONDEK SLAB
CB	UNDERSIDE OF CONCRETE BAND BEAM
CFC	COMPRESSED FIBRE CEMENT SHEETING SUCH AS HARDIEFLEX
FPB	FLUSHED AND PAINTED PLASTERBOARD
FTR	FASCIA TRUSS
RC	RECESSED CEILING CURTAIN TRACK
TB	TIMBER-LOOK BATTENED CEILING - INNOCEIL SHIPLAP CEILING CLADDING IN WESTERN RED CEDAR, INSTALLED TO MANUF. DTLS
WPB	WATERPROOF FLUSHED PLASTERBOARD CEILING WITH MOULD RESISTANT PAINT

ENSURE ALL LOAD BEARING STEEL NOT WITHIN A FIRE RATED WALL (WT8 & WT9) HAS PROMAT CAFCO 300 VERMICULITE APPLIED PRIOR TO 1ST FIX SERVICES AND LINING WALLS AND CEILINGS

CROSSHATCHED AREA - R3.7 MIN REQUIRED TO ROOF OF POOL AREA (SYSTEM TOTAL) R13 ANTECON BLANKET TO UNDERSIDE OF ROOF WITH R3.0 CEILING INSULATION BATTS AS AN EXAMPLE FOR ACHIEVING THIS RATING

COFFERED CEILING DROPPED TO 2200AFL AROUND POOL DECK AREA TO ALLOW SPACE FOR DUCTWORK & DRAINAGE AS PER MECHANICAL LAYOUTS. DUCTWORK SIZING TBA

DOTTED AREA - INSULATION BETWEEN POOL DECK AND APARTMENT ABOVE - 4.0mm R2.0 RIGID SOFFIT BOARD OR INSULATION BATTS TO CEILING

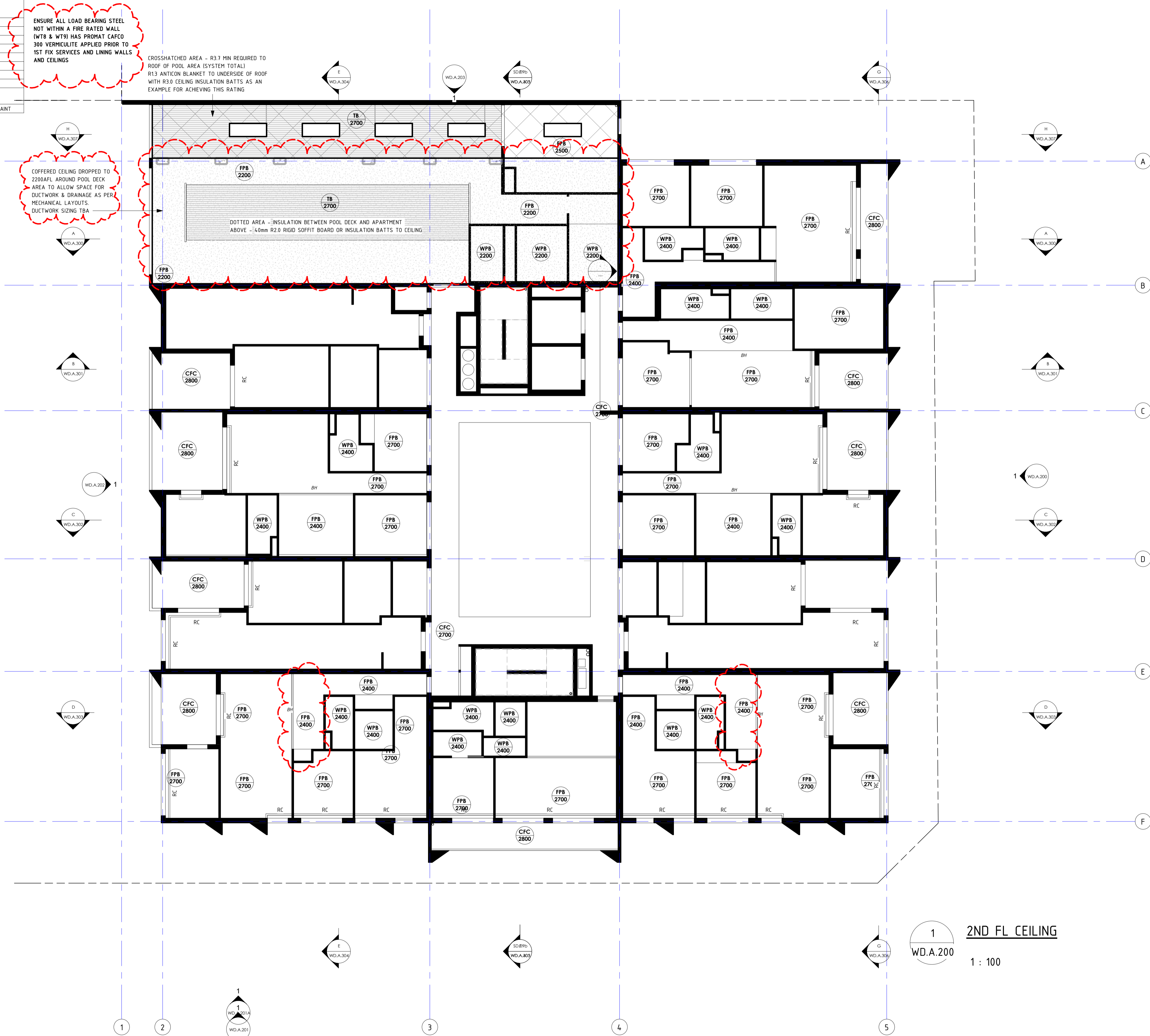

1
WD.A.200
2ND FL CEILING
1 : 100

REVISIONS		
ISSUE #	DATE	DESCRIPTION
A	25/03/2019	FOR BRC APPROVAL
B	14/05/2019	REVISED SET BASED ON BRC RFI PC59515

PROJECT ADDRESS
248 UNLEY ROAD HYDE PARK
HYDE PARK PLACE - STAGE A

CLIENT
HYDE PARK PLACE PTY LTD



SHEET
RCP 2ND FLOOR
WD.A.503

AUTHOR
GB
CURRENT REVISION
REVISED SET BASED ON
BRC RFI PC59515

ISSUE DATE
29/06/2019
FOR TENDER

